

10 MAINTENANCE AND CLEANING

The following points have to be considered during the inspection:

- 1) All screws for installing the device or parts of the device have to be tightly connected and must not be corroded.
- 2) There must not be any deformations on the housing, color lenses, fixations and installation spots (ceiling, suspension, trussing).
- 3) Mechanically moved parts must not show any traces of wearing and must not rotate with unbalances.
- 4) The electric power supply cables must not show any damage, material fatigue or sediments.

Further instructions depending on the installation spot and usage have to be adhered by a skilled installer and any safety problems have to be removed.



CAUTION

Disconnect from mains before starting maintenance operation.



In order to make the lights in good condition and to extend the lifetime, we suggest a regular cleaning to the lights.

- 1) Clean the inside and outside lens each week to avoid the weakness of the lights due to accumulation of dust.
- 2) Clean the fan each week.
- 3) A detailed electric check by approved electrical engineer each three months, make sure that the circuit contacts are in good condition, prevent the poor contact of circuit from overheating.

We recommend a frequent cleaning of the device. Please use a moist, lint-free cloth. Never use alcohol solvents.

There are no serviceable parts inside the device. Please refer to the instructions under "Installation instructions".

Should you need any spare parts, please order genuine parts from your local dealer.

STECHNICS

LZOOM RGBW740

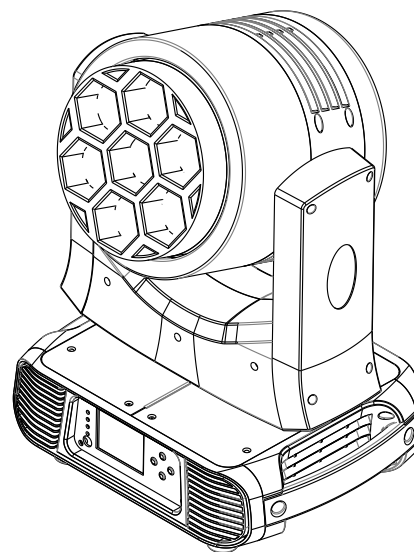

CE F IP20 LED $\text{---}0.2\text{m}$ $t_a 40^\circ\text{C}$ $t_c 150^\circ\text{C}$

User Manual

KEEP THIS MANUAL FOR FUTURE NEEDS

1 SAFETY INSTRUCTIONS



CAUTION

Becareful with your operations. With a dangerous voltage you can suffer a dangerous electric shock when touching wires!

This device has left the factory in perfect condition. In order to maintain this condition and to ensure a safe operation, it is absolutely necessary for the user to follow the safety instructions and warning notes written in this user manual.



IMPORTANT

Damages caused by the disregard of this user manual are not subject to warranty. The dealer will not accept liability for any resulting defects or problems.

If the device has been exposed to temperature changes due to environmental changes, do not switch it on immediately. The arising condensation could damage the device. Leave the device switched off until it has reached room temperature.

This device falls under protection-class I. Therefore it is essential that the device be earthed.

The electric connection must carry out by qualified person.

The device shall only be used with rate voltage and frequency.

Make sure that the available voltage is not higher than stated at the end of this manual.

Make sure the power cord is never crimped or damaged by sharp edges. If this would be the case, replacement of the cable must be done by an authorized dealer.

Always disconnect from the mains, when the device is not in use or before cleaning it. Only handle the power cord by the plug. Never pull out the plug by tugging the power cord.

During initial start-up some smoke or smell may arise. This is a normal process and does not necessarily mean that the device is defective, it should decrease gradually.

Please don't project the beam onto combustible substances.

Fixtures cannot be installed on combustible substances, keep more than 50cm distance with wall for smooth air flow, so there should be no shelter for fans and ventilation for heat radiation.

If the external flexible cable or cord of this luminaire is damaged, it shall be exclusively replaced by the manufacturer or his service agent or a similar qualified person in order to avoid a hazard.

| | | | | | | |
|----------|--------------------|----|----|------------------|----------|--|
| 31 | 25 | | | White in pixel 2 | 0..255 | White in pixel 2 saturation control(0-100%) |
| 32 | 26 | | | Red in Pixel 3 | 0..255 | Red in pixel 3 saturation control (0-100%) |
| 33 | 27 | | | Green in pixel 3 | 0..255 | Green in pixel 3 saturation control(0-100%) |
| 34 | 28 | | | Blue in pixel 3 | 0..255 | Blue in pixel 3 saturation control(0-100%) |
| 35 | 29 | | | White in pixel 3 | 0..255 | White in pixel 3 saturation control(0-100%) |
| 36 | 30 | | | Red in Pixel 4 | 0..255 | Red in pixel 4 saturation control (0-100%) |
| 37 | 31 | | | Green in pixel 4 | 0..255 | Green in pixel 4 saturation control(0-100%) |
| 38 | 32 | | | Blue in pixel 4 | 0..255 | Blue in pixel 4 saturation control(0-100%) |
| 39 | 33 | | | White in pixel 4 | 0..255 | White in pixel 4 saturation control(0-100%) |
| 40 | 34 | | | Red in Pixel 5 | 0..255 | White in pixel 5 saturation control (0-100%) |
| 41 | 35 | | | Green in pixel 5 | 0..255 | Green in pixel 5 saturation control(0-100%) |
| 42 | 36 | | | Blue in pixel 5 | 0..255 | Blue in pixel 5 saturation control(0-100%) |
| 43 | 37 | | | White in pixel 5 | 0..255 | White in pixel 5 saturation control(0-100%) |
| 44 | 38 | | | Red in Pixel 6 | 0..255 | White in pixel 6 saturation control (0-100%) |
| 45 | 39 | | | Green in pixel 6 | 0..255 | Green in pixel 6 saturation control(0-100%) |
| 46 | 40 | | | Blue in pixel 6 | 0..255 | Blue in pixel 6 saturation control(0-100%) |
| 47 | 41 | | | White in pixel 6 | 0..255 | White in pixel 6 saturation control(0-100%) |
| 48 | 42 | | | Red in Pixel 7 | 0..255 | White in pixel 7 saturation control (0-100%) |
| 49 | 43 | | | Green in pixel 7 | 0..255 | Green in pixel 7 saturation control(0-100%) |
| 50 | 44 | | | Blue in pixel 7 | 0..255 | Blue in pixel 7 saturation control(0-100%) |
| 51 | 45 | | | White in pixel 7 | 0..255 | White in pixel 7 saturation control(0-100%) |
| 52 | 46 | 20 | 14 | Special Function | 0..19 | No function |
| | | | | | 20..29 | Dimmer Speed Fast |
| | | | | | 30..39 | Dimmer Speed Smooth |
| | | | | | 40..49 | Dimmer Curve Linear |
| | | | | | 50..59 | Dimmer Curve SQ |
| | | | | | 60..69 | Dimmer Curve Inv. SQ |
| | | | | | 70..79 | Dimmer Curve S. |
| | | | | | 80-89 | All motor reset |
| | | | | | 90-94 | Scan motor reset |
| | | | | | 95-99 | Focus motor reset |
| | | | | | 100..119 | Internal program 1 |
| | | | | | 120..139 | Internal program 2 |
| | | | | | 140..159 | Internal program 3 |
| | | | | | 160..179 | Internal program 4 |
| | | | | | 180..199 | Internal program 5 |
| 200..219 | Internal program 6 | | | | | |
| 220..239 | Internal program 7 | | | | | |
| 240..255 | Function Null | | | | | |

| | | | | | |
|----|----|----|---|----------|--|
| 22 | 16 | 18 | Dynamic Patterns | 116..122 | Dynamic Scene13 |
| | | | | 123..129 | Dynamic Scene14 |
| | | | | 130..136 | Dynamic Scene15 |
| | | | | 137..143 | Dynamic Scene16 |
| | | | | 144..150 | Dynamic Scene17 |
| | | | | 151..157 | Dynamic Scene18 |
| | | | | 158..164 | Dynamic Scene19 |
| | | | | 165..171 | Dynamic Scene20 |
| | | | | 172..178 | Dynamic Scene21 |
| | | | | 179..185 | Dynamic Scene22 |
| | | | | 186..192 | Dynamic Scene23 |
| | | | | 193..199 | Dynamic Scene24 |
| | | | | 200..206 | Dynamic Scene25 |
| | | | | 207..213 | Dynamic Scene26 |
| | | | | 214..220 | Dynamic Scene27 |
| | | | | 221..227 | Dynamic Scene28 |
| | | | | 228..234 | Dynamic Scene29 |
| | | | | 235..241 | Dynamic Scene30 |
| | | | | 242..248 | Dynamic Scene31 |
| | | | | 249..255 | Dynamic Scene32 |
| | | | Static Patterns or Patterns Speed | 000..007 | Static scene1 |
| | | | | 008..015 | Static scene2 |
| | | | | 016..023 | Static scene3 |
| | | | | 024..031 | Static scene4 |
| | | | | 032..039 | Static scene5 |
| | | | | 040..047 | Static scene6 |
| | | | | 048..055 | Static scene7 |
| | | | | 056..063 | Static scene8 |
| | | | | 064..071 | Static scene9 |
| | | | | 072..079 | Static scene10 |
| | | | | 080..087 | Static scene11 |
| | | | | 088..095 | Static scene12 |
| | | | | 096..103 | Static scene13 |
| | | | | 104..111 | Static scene14 |
| | | | | 112..119 | Static scene15 |
| | | | | 120..127 | Static scene16 |
| | | | | 128..135 | Static scene17 |
| | | | | 136..143 | Static scene18 |
| | | | | 144..151 | Static scene19 |
| | | | | 152..159 | Static scene20 |
| | | | | 160..167 | Static scene21 |
| | | | | 168..175 | Static scene22 |
| | | | | 176..183 | Static scene23 |
| | | | | 184..191 | Static scene24 |
| | | | | 192..199 | Static scene25 |
| | | | | 200..207 | Static scene26 |
| | | | | 208..215 | Static scene27 |
| | | | | 216..223 | Static scene28 |
| | | | | 224..231 | Static scene29 |
| | | | | 232..239 | Static scene30 |
| | | | | 240..247 | Static scene31 |
| | | | | 248..255 | Static scene32 |
| | | | Dynamic Patterns Speed (If channel 23 is in the interval 032 – | 000..023 | No function |
| | | | | 024..137 | Forward speed from zero speed to fast speed |
| | | | | 138..141 | Stop movement |
| | | | | 142..255 | Reverse speed from zero speed to fast speed |
| 24 | 18 | | Red in Pixel 1 | 0..255 | Red in pixel 1 saturation control (0-100%) |
| 25 | 19 | | Green in Pixel 1 | 0..255 | Green in pixel 1 saturation control (0-100%) |
| 26 | 20 | | Blue in Pixel 1 | 0..255 | Blue in pixel 1 saturation control(0-100%) |
| 27 | 21 | | White in pixel 1 | 0..255 | White in pixel 1 saturation control(0-100%) |
| 28 | 22 | | Red in pixel 2 | 0..255 | Red in pixel 2 saturation control(0-100%) |
| 29 | 23 | | Green in pixel 2 | 0..255 | Green in pixel 2 saturation control(0-100%) |
| 30 | 24 | | Blue in pixel 2 | 0..255 | Blue in pixel 2 saturation control(0-100%) |

2 UNPACKING

Thank you for choosing our LZOOM RGBW740. For your own safety, please read this manual before installing the device. This manual covers the important information on installation and applications. Please install and operate the fixture with following instructions. Meanwhile, please keep this manual well for future needs.

The LZOOM RGBW740 is made of a new type of high temperature strength of engineering plastics and cast aluminum casing with nice outlook. The fixture is designed and manufactured strictly following CE standards, complying with international standard DMX512 protocol. It's available independently controlled and linkable with each other for operation. And it is applicable for large-scale live performances, theater, studio, nightclubs and discos.

The LZOOM RGBW740 adopts 7PCS 4-IN-1 40W LEDs which features high brightness and stability. Please carefully unpack it when you receive the fixture and check whether it is damaged during the transportation. And please check whether the following items are included inside the box:

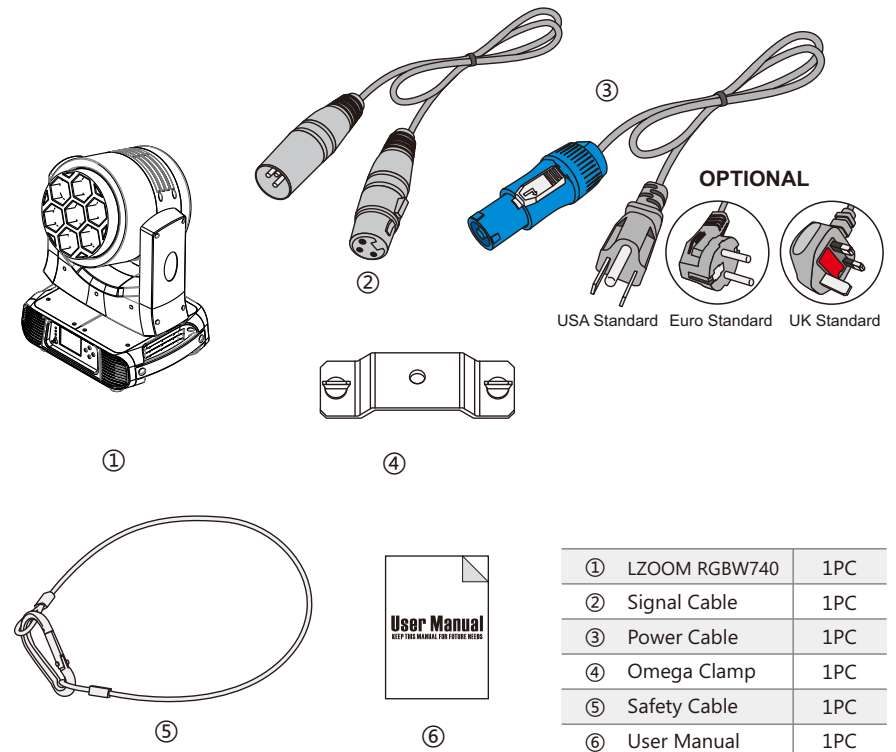

| | | |
|---|---------------|-----|
| ① | LZOOM RGBW740 | 1PC |
| ② | Signal Cable | 1PC |
| ③ | Power Cable | 1PC |
| ④ | Omega Clamp | 1PC |
| ⑤ | Safety Cable | 1PC |
| ⑥ | User Manual | 1PC |

3 FEATURES & SPECIFICATIONS

Features

- 7*40W OSRAM 4-IN-1 RGBW LEDs
- 50,000 hours lifespan and low power consumption
- Pixel mapping capability with each LEDs controllable individually
- Specific optic lens of highly efficient elements integrated with glass tube
- Fast, smooth and quiet motorized zoom with 5° -62° range
- Even, soft edge and pure color mixing coverage
- Flicker free sources management
- 8/16 Bit smooth, fast and precise PAN/TILT movement
- 540° PAN and 270° TILT movement
- PAN/TILT reversible advantage
- PAN/TILT calibration available
- Scan position memory, auto reposition after unexpected movement
- 0-100% Smooth linear LED dimmer
- Fine dimmer available
- 5 Dimmer modes (default, standard, stage, TV, theatre) and 4 dimmer curves (default, linear, square law, inv SQ law)
- Different pre-programming virtual colors and linear color temperature adjustment
- Linear color temperature adjustment from 2800K to 8000K
- Virtual tungsten lamp simulation effect from 2800K-3200K
- Different pre-programming dynamic patterns with variable speed and bi-directional rotation
- Different pre-programming static patterns
- Different foreground color options and linear color temperature adjustments for dynamic/static PATTERNS, with 0-100% linear dimmer
- Different background color options and linear color temperature adjustments for dynamic/static PATTERNS, with 0-100% linear dimmer
- Different built-in default programs for easy operation
- 10 Kinds of variable speed strobe effect with 1-25 flashes per second
- 14/20/46/52 CH DMX channel modes (USITT DMX-512)
- DMX512, master-slave, and sound activated controllable or auto operation
- DMX recorder and edit function integrated
- Sound control with sensitivity adjustment
- RDM available (Remote Device Management)
- Art-NET as optional
- Wireless Solution' s wireless receiver system built-in as optional
- 2.4" TFT LCD display (320*240pix) with 4 control buttons and battery back-up for menu preset
- 180° Reversible for LCD display
- LCD display switch-off automatically after 60 seconds
- DMX signal monitoring indicator available
- Software up-datable through DMX connectors
- Efficient low noise self adjusting fan cooling system
- Constant temperature readout and management function

| | | | | | |
|----------|-----------------|----|-------------------------------|----------|---|
| 18 | 12 | 14 | Foreground Color for Patterns | 1..13 | Red |
| | | | | 14..27 | Green |
| | | | | 28..41 | Blue |
| | | | | 42..55 | White |
| | | | | 56..69 | Red+White |
| | | | | 70..83 | Green+White |
| | | | | 84..97 | Blue+White |
| | | | | 98..111 | Green+Blue |
| | | | | 112..125 | Red+Blue |
| | | | | 126..139 | Red+Green |
| | | | | 140..153 | Green+Blue+White |
| | | | | 154..167 | Red+Blue+White |
| | | | | 168..181 | Red+Green+White |
| | | | | 182..195 | Red+Blue+Green+White |
| | | | | 196..202 | 2700K |
| 203..209 | 3200K | | | | |
| 210..216 | 3500K | | | | |
| 217..223 | 5000K | | | | |
| 224..230 | 5500K | | | | |
| 231..237 | 6000K | | | | |
| 238..244 | 6500K | | | | |
| 245..251 | 7000K | | | | |
| 252..255 | 8000K | | | | |
| 19 | 13 | 15 | Foreground Dimmer | 000..255 | Foreground dimmer 0 - 100%. |
| 20 | 14 | 16 | Background Color for Patterns | 0..0 | No Function |
| | | | | 1..13 | Red |
| | | | | 14..27 | Green |
| | | | | 28..41 | Blue |
| | | | | 42..55 | White |
| | | | | 56..69 | Red+White |
| | | | | 70..83 | Green+White |
| | | | | 84..97 | Blue+White |
| | | | | 98..111 | Green+Blue |
| | | | | 112..125 | Red+Blue |
| | | | | 126..139 | Red+Green |
| | | | | 140..153 | Green+Blue+White |
| | | | | 154..167 | Red+Blue+White |
| | | | | 168..181 | Red+Green+White |
| | | | | 182..195 | Red+Blue+Green+White |
| 196..202 | 2700K | | | | |
| 203..209 | 3200K | | | | |
| 210..216 | 3500K | | | | |
| 217..223 | 5000K | | | | |
| 224..230 | 5500K | | | | |
| 231..237 | 6000K | | | | |
| 238..244 | 6500K | | | | |
| 245..251 | 7000K | | | | |
| 252..255 | 8000K | | | | |
| 21 | 15 | 17 | Background Dimmer | 000..255 | Background dimmer 0 - 100%. |
| | | | | 000..015 | No function and 24th channel behind pixel can control |
| | | | | 016..031 | 24th Channel display static scene |
| | | | | 032..038 | Dynamic Scene1 |
| | | | | 039..045 | Dynamic Scene2 |
| | | | | 046..052 | Dynamic Scene3 |
| | | | | 053..59 | Dynamic Scene4 |
| | | | | 060..066 | Dynamic Scene5 |
| | | | | 067..073 | Dynamic Scene6 |
| | | | | 074..080 | Dynamic Scene7 |
| | | | | 081..087 | Dynamic Scene8 |
| | | | | 088..094 | Dynamic Scene9 |
| | | | | 095..101 | Dynamic Scene10 |
| 102..108 | Dynamic Scene11 | | | | |
| 109..115 | Dynamic Scene12 | | | | |

9 DMX CHANNELS

| Mode/Channel | | | | Function | Value | Function |
|--------------|---------|----|----|-----------------|----------|---|
| 52 | 46 | 20 | 14 | | | |
| 1 | 1 | 1 | 1 | PAN | 0..255 | PAN Movement |
| 2 | 2 | 2 | 2 | PAN Fine | 0..255 | Fine control of Pan movement |
| 3 | 3 | 3 | 3 | TILT | 0..255 | Tilt Movement |
| 4 | 4 | 4 | 4 | TILT Fine | 0..255 | Fine control of Tilt movement |
| 5 | 5 | 5 | 5 | Speed PAN/TILT | 0..225 | max to min speed |
| | | | | | 226..235 | blackout by movement |
| | | | | | 236..255 | no function |
| 6 | 6 | 6 | 6 | Dimmer | 0..255 | Dimmer 0%...100% |
| 7 | 7 | | | Dimmer Fine | 0..255 | Fine control of dimmer |
| 8 | 8 | 7 | 7 | Sutter | 0..31 | Shutter closed |
| | | | | | 32..63 | shutter open |
| | | | | | 64..95 | Strobe effect slow to fast |
| | | | | | 96..127 | shutter open |
| | | | | | 128..159 | Pulse-effect in sequences slow to fast |
| | | | | | 160..191 | shutter open |
| | | | | | 192..255 | shutter open |
| 9 | | 8 | 8 | Red | 0..255 | 0-100% Red dimmer from dark to bright |
| 10 | | 9 | 9 | Green | 0..255 | 0-100% Green dimmer from dark to bright |
| 11 | | 10 | 10 | Blue | 0..255 | 0-100% Blue dimmer from dark to bright |
| 12 | | 11 | 11 | White | 0..255 | 0-100% White dimmer from dark to bright |
| 13 | 9 | 12 | 12 | Zoom | 0..255 | In(near) to out(far) |
| 14 | 10 | | | Zoom Fine | 0..255 | Fine control of zoom |
| 15 | 11 | 13 | 13 | Color Macro | 000-009 | Open |
| | | | | | 010-017 | Color1 |
| | | | | | 018-024 | Color2 |
| | | | | | 025-032 | Color3 |
| | | | | | 033-039 | Color4 |
| | | | | | 040-047 | Color5 |
| | | | | | 048-054 | Color6 |
| | | | | | 055-061 | Color7 |
| | | | | | 062-069 | Color8 |
| | | | | | 070-076 | Color9 |
| | | | | | 077-084 | Color10 |
| | | | | | 085-091 | Color11 |
| | | | | | 092-099 | Color12 |
| | | | | | 100-106 | Color13 |
| | | | | | 107-113 | Color14 |
| | | | | | 114-121 | Color15 |
| | | | | | 122-128 | Color16 |
| | | | | | 129-136 | Color17 |
| | | | | | 137-143 | Color18 |
| | | | | | 144-151 | Color19 |
| | | | | | 152-158 | Color20 |
| | | | | | 159-165 | Color21 |
| | | | | | 166-173 | Color22 |
| | | | | | 174-180 | Color23 |
| | | | | | 181-188 | Color24 |
| | | | | | 189-195 | Color25 |
| | | | | | 196-203 | Color26 |
| | | | | | 204-210 | Color27 |
| | | | | | 211-217 | Color28 |
| | | | | | 218-225 | Color29 |
| | | | | | 226-232 | Color30 |
| | | | | | 233-240 | Color31 |
| | | | | | 241-247 | Color32 |
| 248-255 | Color33 | | | | | |
| 16 | | | | | 0 | No Function |
| | | | | | 001-255 | 8000K-3200K |
| | | | | | 0..15 | No Function |
| 17 | | | | Visual Tungsten | 16..255 | 3200K-2800K |
| | | | | | 0..0 | No Function |
| | | | | | | |

- Over heat protection management
- Powercon IN/ OUT with power switch and fuse
- 3-Pin XLR DMX connectors IN/OUT
- IP20 protection rating
- -20~45° C ambient temperature
- 2*1/4 turn fastening Omega Clamps (Adaptable vertically and horizontally)
- 1*Safety attachment point
- CE (EMC/LVD) and RoHS certified

Specifications

Input Voltage: AC100-240V 50/60Hz

LED Quantities: 7*40W OSRAM 4-IN-1 RGBW LEDs

Control Signal: RDM, DMX512, master-slave and sound activated or auto operation

Control Channel: 14/20/46/52 DMX channel modes

Power Consumption: 350W

Dimensions: 279(D)*421(W)*411(H)mm

Packing Dimensions: 280(D)*490(W)*560(H)mm

Net Weight: 10kg

Gross Weight: 13kg

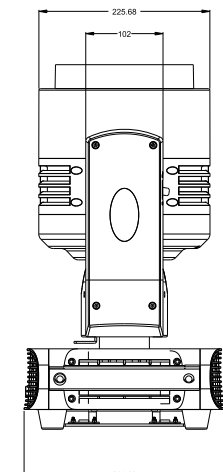
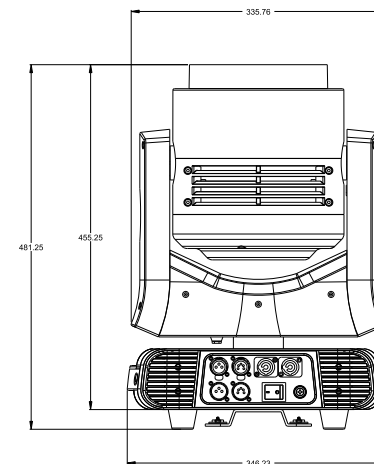

4 PHOTOMETRIC DATA

Photometric Beam Angle Data⁸ ~62° Beam Angle LUX × 0.0929=FC

| | | | | | |
|-------------|----------------------------|-------------------------|------------------------|----------------------|------------------------|
| R | 654 / 7040 96 / 1037 | 92 / 990 7 / 77 | 32 / 341 2 / 25 | 16 / 177 1 / 12 | |
| G | 880 / 9460 130 / 1386 | 131 / 1408 17 / 184 | 45 / 500 3 / 36 | 23 / 250 1 / 16 | |
| B | 920 / 9900 134 / 1448 | 143 / 1540 10 / 110 | 50 / 536 3 / 40 | 25 / 270 1 / 19 | |
| W | 1206 / 12980 170 / 1830 | 180 / 1941 13 / 144 | 70 / 740 5 / 51 | 387 / 352 2 / 26 | |
| RGBW | 3198 / 34430 350 / 3756 | 522 / 5624 470 / 426 | 201 / 2167 14 / 154 | 101 / 1100 7 / 80 | (8°) (62°) (FC/LUX) |

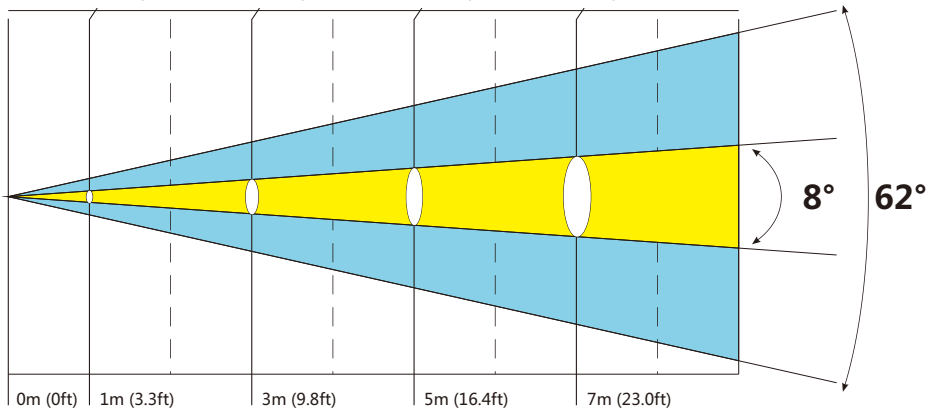

5 OPERATION INSTRUCTIONS

- The LZOOM RGBW740 is for wash effect for on-site decoration purpose.
- Don't turn on the fixture if it's been through severe temperature difference like after transportation because it might damage the light due to the environment changes. So make sure to operate the fixture until it is in normal temperature.
- This light should be keep away from strong shaking during any transportation or movement.
- Don't pull up the light by only the head, or it might cause damages to the mechanical parts.
- Don't expose the fixture in overheat, moisture or environment with too much dust when installing it. And don't lay any power cables on the floor. Or it might cause electronic shock to the people.
- Make sure the installation place is in good safety condition before installing the fixture.

| | | | |
|---------------------|---------------------|---------|--|
| Display Setting | Display Inverse | No | |
| | | Yes | |
| | Backlight Auto Off | No | |
| | | Yes | |
| | Display Intensity | 0-10 | |
| Temperature Unit | | °C | |
| | | °F | |
| Language | | English | |
| | | Chinese | |
| Fixture Test | Auto Test | | |
| | Manual Test | | |
| Fixture Information | Fixture use time | | |
| | Fixture Temperature | | |
| | Firmware Version | | |
| Reset Functions | Pan/Tilt | No | |
| | | Yes | |
| | Zoom/Rotation | No | |
| | | Yes | |
| All | No | | |
| | Yes | | |
| Special Functions | Factory Default | No | |
| | | Yes | |

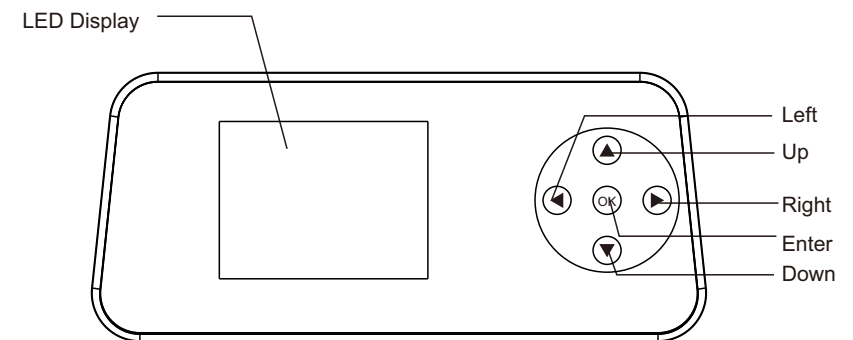

8 MENU OPERATIONS

| | | | | | |
|-----------------|----------------------|------------------|-------------------|--|--|
| MENU | DMX Functions | Dmx Addr | 001-512 | | |
| | | DMX Channel Mode | Mode1(14) | | |
| | | | Mode2(20) | | |
| | | | Mode3(46) | | |
| | | | Mode4(52) | | |
| | | DMX State | BlackOut | | |
| | | | M/S Mode | | |
| | | | Hold | | |
| | | Connect to | XLR Priority | | |
| | | | Wireless Priority | | |
| | | | Wireless Only | | |
| | | | ArtNet Only | | |
| | | DMX Retransmit | XLR Only | | |
| | Yes | | | | |
| | Un-Link Wireless | No | | | |
| | | Yes | | | |
| | Ethernet IP Settings | No | | | |
| | | IP Address | | | |
| | ArtNet Settings | Subnet Mask | | | |
| Net | | 000-255 | | | |
| View DMX Value | | | | | |
| Show Setting | Auto Mode | Auto 1 | | | |
| | | Auto 2 | | | |
| | | Auto 3 | | | |
| | | Auto 4 | | | |
| Sound Active | Yes | | | | |
| | No | | | | |
| Mic Sensitivity | 000-100 | | | | |
| Fixture Setting | Pan Inverse | No | | | |
| | | Yes | | | |
| | Tilt Inverse | No | | | |
| | | Yes | | | |
| | P/T Feedback | No | | | |
| | | Yes | | | |
| | White Balance | Red | 125-255 | | |
| | | Green | 125-255 | | |
| | | Blue | 125-255 | | |
| | | White | 125-255 | | |
| | Dimmer Curve | Linear | | | |
| | | Square Law | | | |
| Inverse Squ. | | | | | |
| S-Curve | | | | | |
| Dimmer Speed | Fast | | | | |
| | Smooth | | | | |

- Make sure to put the safety chain and check whether the screws are screwed properly when installing the fixture.
- Make sure the lens are in good condition. It's recommended to replace the units if there are any damages or severe scratch.
- Make sure the fixture is operated by qualified personnel who knows the fixture before using.
- Keep the original packages if any second shipment is needed.
- Don't try to change the fixtures without any instruction by the manufacturer or the appointed repairing agencies.
- It is not in warranty range if there are any malfunctions from not following the user manual to operate or any illegal operation, like shock short circuit, electronic shock, lamp broke, etc.

6 INSTALLATIONS

Cautions: For added protection mount the fixtures in areas outside walking paths, seating areas, or in areas were the fixture might be reached by unauthorized personnel.

Before mounting the fixture to any surface, make sure that the installation area can hold a minimum point load of 10 times the device's weight.

Fixture installation must always be secured with a secondary safety attachment, such as an appropriate safety cable.

Never stand directly below the device when mounting, removing, or servicing the fixture.

from a ceiling, or set on a flat level surface (see illustration below). Be sure this fixture is kept at least 0.5m (1.5 ft) away from any flammable materials (decoration etc.).

Always use and install the supplied safety cable as a safety measure to prevent accidental damage and/or injury in the event the clamp fails.

Mounting points: Overhead mounting requires extensive experience, including amongst others calculating working load limits, a fine knowledge of the installation material being used, and periodic safety inspection of all installation material and the fixture. If you lack these qualifications, do not attempt the installation yourself. Improper installation can result in bodily injury.

Be sure to complete all rigging and installation procedures before connecting the main power cord to the appropriate wall outlet.

Clamp Mounting: The LZOOM RGBW740 provides a unique mounting bracket assembly that integrates the bottom of the base, and the safety cable rigging point in one unit (see the illustration below). When mounting this fixture to truss be sure to secure an appropriately rated clamp to the included omega bracket using a M10 screw fitted through the center hole of the "omega bracket". As an added safety measure be sure to attached at least one properly rated safety cable to the fixture using on of the safety cable rigging point integrated in the base assembly.

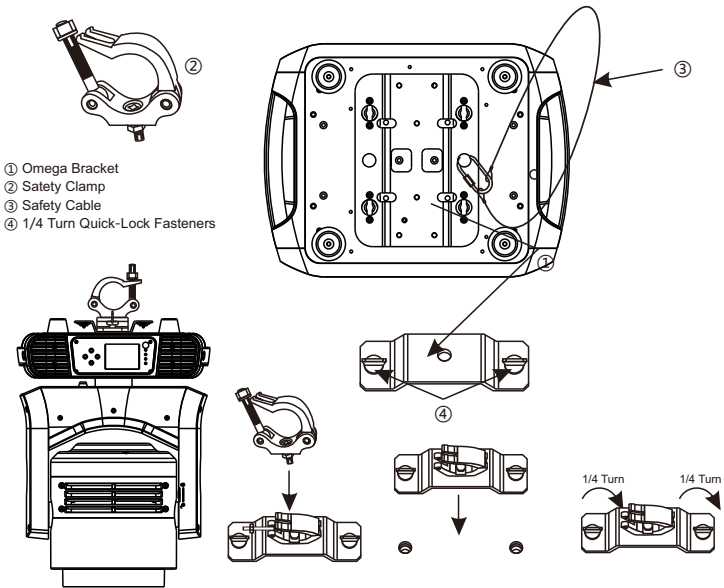

Regardless of the rigging option you choose for your LZOOM RGBW740 always be sure to secure your fixture with a safety cable. The fixture provides a built-in rigging point for a safety cable on the hanging bracket as illustrated above. Be sure to only use the designated rigging point for the safety cable and never secure a safety cable to a carrying handle.

7 DMX-512 CONTROL CONNECTIONS

Connect the provided XLR cable to the female 3-pin XLR output of your controller and the other side to the male 3-pin XLR input of the moving head. You can chain multiple

Moving head together through serial linking. The cable needed should be two core, screened cable with XLR input and output connectors. Please refer to the diagram below.

DMX-512 connection with DMX terminator

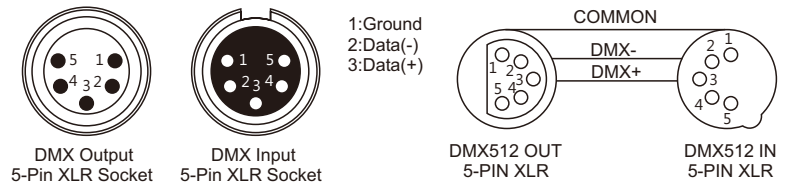
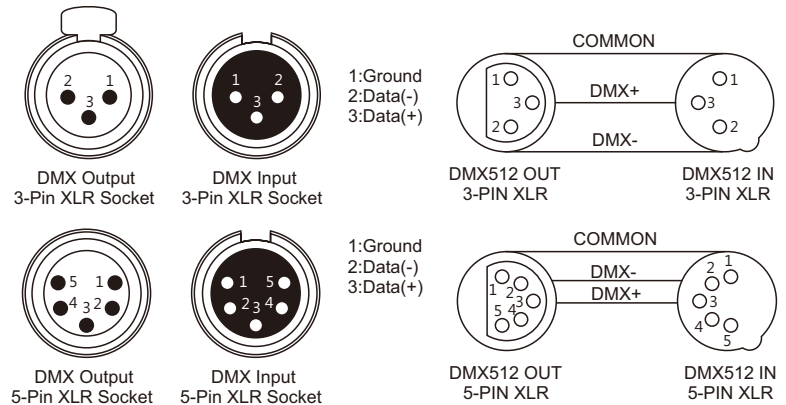
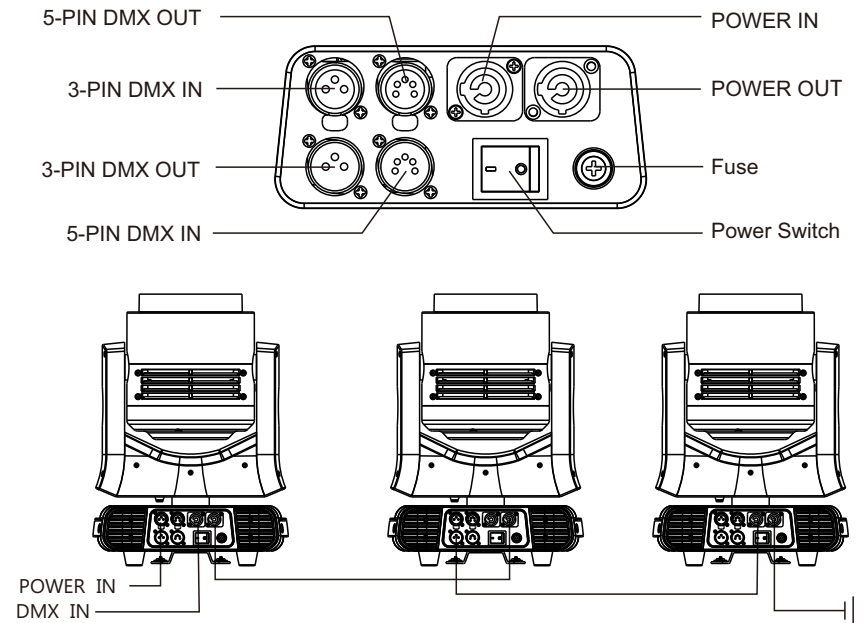

For installations where the DMX cable has to run a long distance or is in an electrically noisy environment, such as in a discotheque, it is recommended to use a DMX terminator. This helps in preventing corruption of the digital control signal by electrical noise. The DMX terminator is simply an XLR plug with a 120 Ω resistor connected between pins 2 and 3, which is then plugged into the output XLR socket of the last fixture in the chain. Please see illustrations below.

